

HSF

NOTES:
 Current Rating: 1.0AMP
 Contact Resistance: 20mΩ Max
 Withstand Voltage: 500V AC/DC
 Insulation Resistance: 1000MΩ Min
 Operation Temperature: -40°C to +105°C

Contact Material: Phosphor Bronze
 Contact plating: Sn over Ni
 Insulator Material: LCP+30%G.F UL94V-0

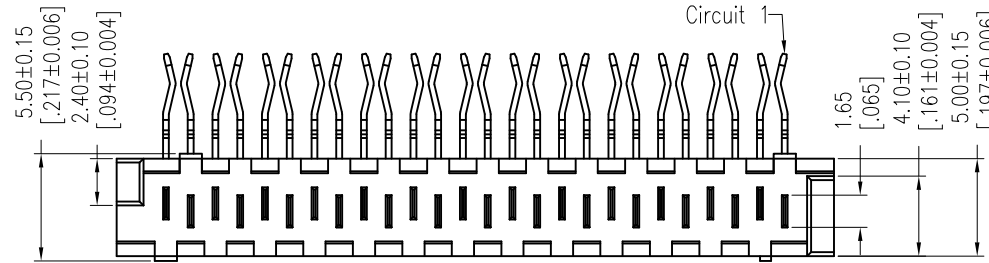

Recommended P.C.B Layout (Top Side)
 (PCB BOARD TOLERANCE ±0.05)

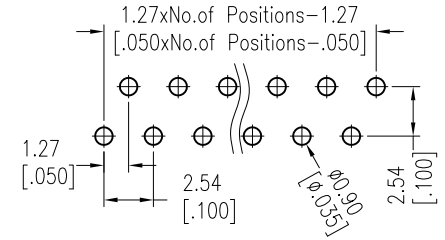

Ordering Information

3901-XX MR XX D N B X 1

No. of Pins	Contact Plating	Insulator	Color	Packing
04	16	SM=Matte Tin	D=LCP	B=Black T=Tube
06	18	SN=Tin		
08	20			
10	22			
12	24			
14	26			

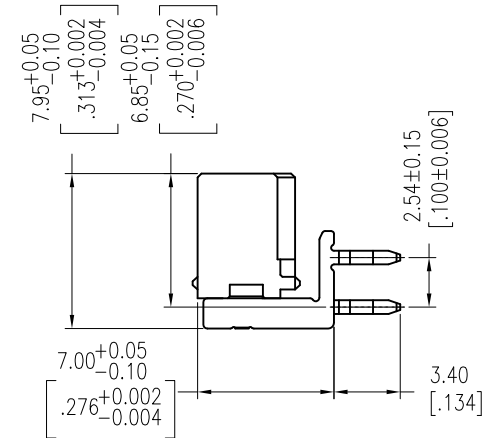
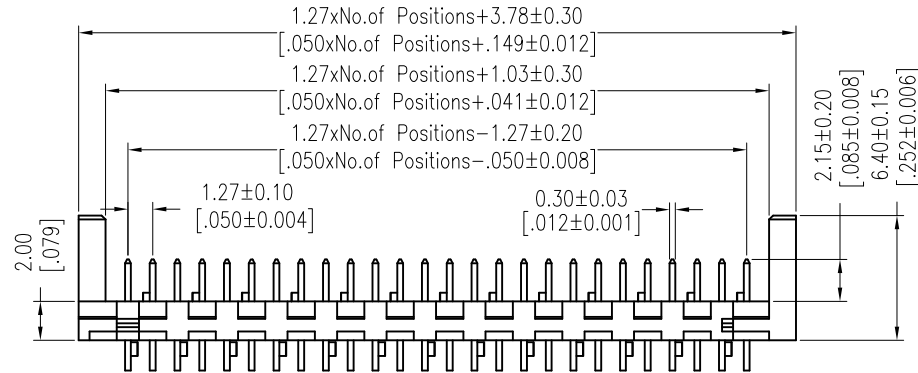

REV	DATE	MODIFICATION DESCRIPTION	CHANGE	OPERATION	DRAW	DATE	SCALE	FIT	PART NO.
				x.x ±0.40	Ding	2018/05/15	UNIT	mm	3901-XXMRXXDNBX1
A1	2018/05/15	Picoflex Connector--1.27mm SPC Connector	-----	x.xx ±0.25	CHECK	DATE	SIZE	A4	TITLE: 1.27mm SPC Connector 90°
A0	2012/11/01	NEW	-----	x.xxx ±0.15	APPROVE	DATE	SHEET	1/1	Customer NO.
				Angle ± 3'			PROJ.		
				DIM TOL					